

p700000.2 700-700-018 / Transmission

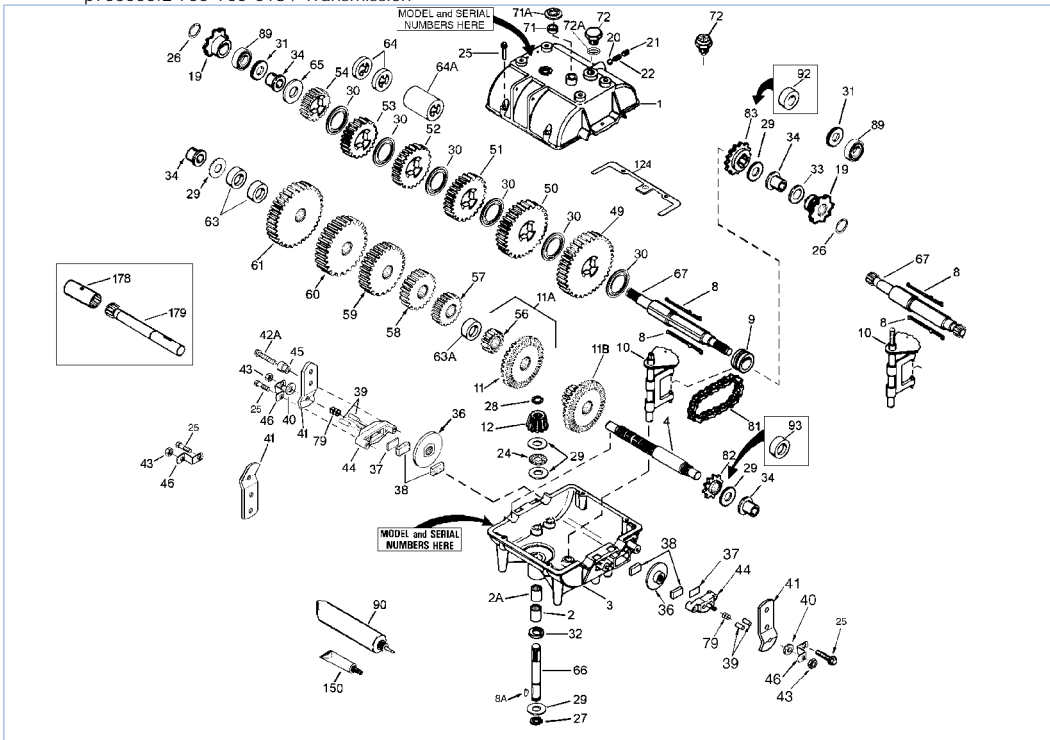

Part List

p700000.2 700-700-018 / Transmission

| REF # | ITEM # | DESCRIPTION | QTY | REMARK |
|-------|---------|--|-----|--------------------------------|
| 1 | 772083A | Transmission Cover | | |
| 2 | 780086A | Needle Bearing | | |
| 2A | 780086A | Needle Bearing | | |
| 3 | 770061A | Transmission Case | | |
| 4 | 776134 | Countershaft | | |
| 8 | 792089A | Shifter Key | | |
| 9 | 784266 | Shift Collar | | |
| 10 | 784267 | Shift Rod & Fork | | |
| 11 | 778137A | Bevel Gear (42 teeth) | | |
| 12 | 778113A | Input Bevel Pinion | | |
| 19 | 786047 | Sprocket (8 teeth) | | |
| 20 | 792077A | Steel Ball, 5/16" dia. | | |
| 21 | 792078 | Set Screw, 3/8-16 x 3/8" | | |
| 22 | 792079 | Spring | | |
| 25 | 792073A | Screw, 1/4-20 x 1-1/4" | | |
| 26 | 792072 | Retaining Ring | | |
| 27 | 792035 | Retaining Ring | | |
| 28 | 788040 | Retaining Ring | | |
| 29 | 780072 | Thrust Washer | | |
| 30 | 780108 | Thrust Washer | | |
| 30A | 780108 | Thrust Washer | | |
| 32 | 792001 | "O" Ring | | |
| 34 | 780105A | Flanged Bushing | | |
| 49 | 778125 | Spur Gear (35 teeth) | | |
| 50 | 778124A | Spur Gear (30 teeth) | | |
| 51 | 778123A | Spur Gear (25 teeth) | | |
| 52 | 778122A | Spur Gear (22 teeth) | | |
| 53 | 778121A | Spur Gear (20 teeth) | | |
| 56 | 778136 | Spur Gear (15 teeth-steel) | | |
| 57 | 778126A | Spur Gear (20 teeth) | | |
| 58 | 778127A | Spur Gear (25 teeth) | | |
| 59 | 778128A | Spur Gear (28 teeth) | | |
| 60 | 778129A | Spur Gear (30 teeth) | | |
| 65 | 780109 | Thrust Washer (flat) | | |
| 66 | 776199 | Input Shaft (4.609" long) | | |
| 67 | 776232 | Brake Shaft (7-27/32" long) | | |
| 71 | 788069 | Square Cut Seal | | |
| 72 | 792074 | Threaded Plug | | |
| 81 | 786081 | Roller Chain (No. 41 chain, 24 links) | | |
| 82 | 786082 | Sprocket (9 teeth) | | |
| 83 | 786083 | Sprocket (18 teeth) | | |
| 90 | 788067B | Grease | | 32 oz. bottle Bentonite grease |
| 150 | 510334 | Gasket Eliminator (Loctite #515) | | |